

Tutor Presentation

Our Aims



Support your child through every step of their Testwood Journey.

Help your child to achieve their very best.



Student Planner

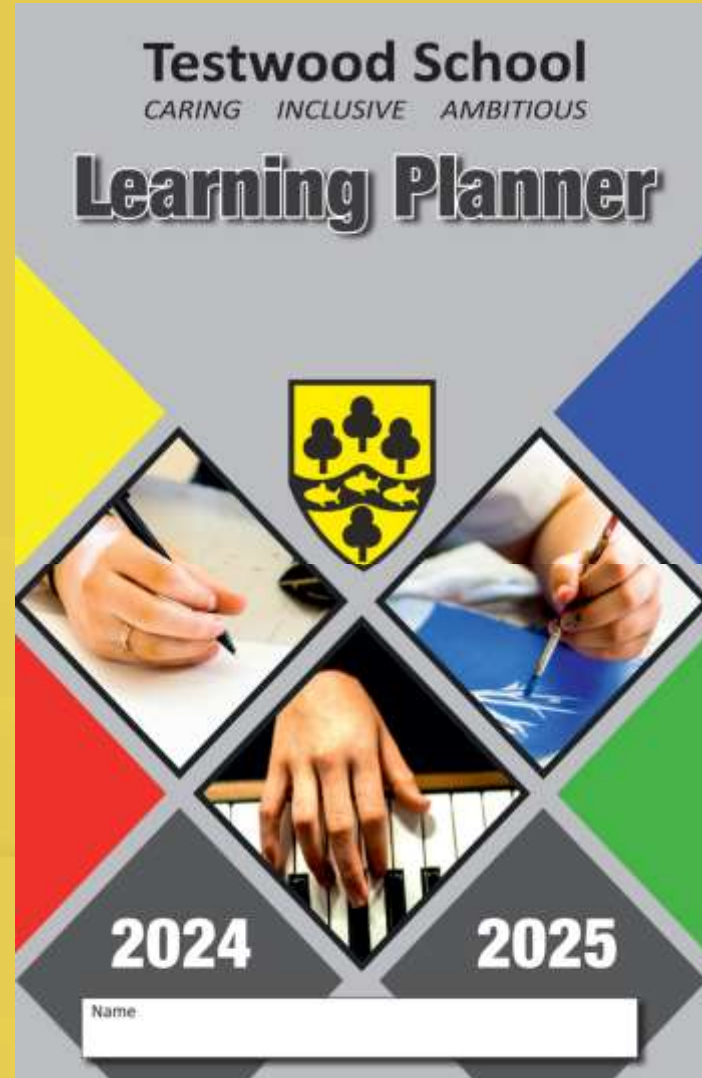

School Map

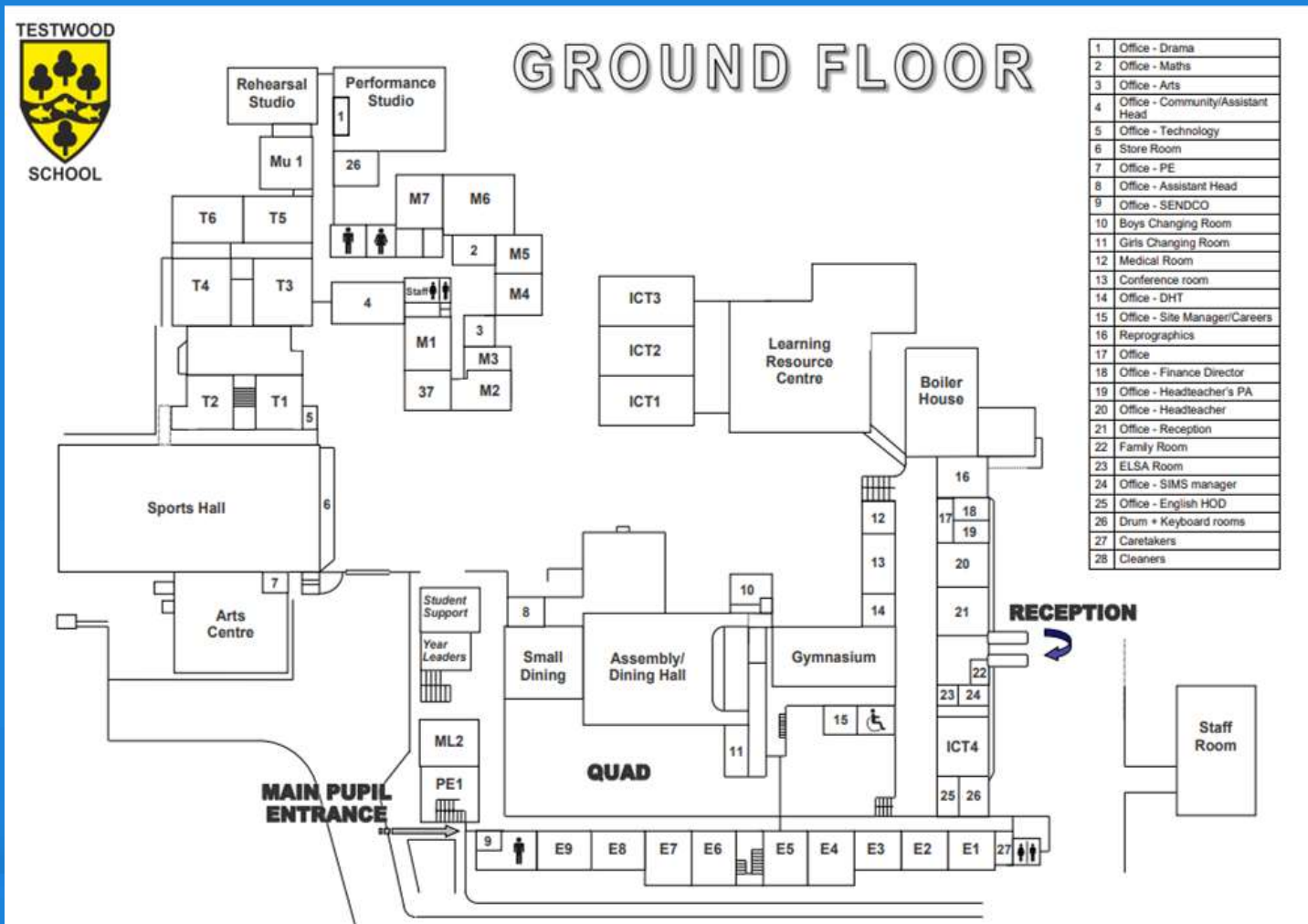

Timetable example (Arbor)



17 Monday	18 Tuesday	19 Wednesday	20 Thursday	21 Friday
08:30-08:50	08:30-08:50	08:30-08:50	08:30-08:50	08:30-08:50
	08:50-09:50 Mathematics (KStg3): Year	08:50-09:50 Mathematics (KStg3): Year	08:50-09:50 Art (KStg3): Year 7:	08:50-09:50 PE (KStg3): Year 7:
09:50-10:50 Music (KStg3): Year 7: 7xy/Mu2	09:50-10:50 History (KStg3): Year 7: 7xy/Hi2	09:50-10:50 English (KStg3): Year 7: 7x/En2	09:50-10:50 Geography (KStg3): Year 7: 7X/Ge5	09:50-10:50 Mathematics (KStg3): Year 7: 7x/Ma1
11:10-12:10 Science (KStg3): Year 7: 7x/Sc2	11:10-12:10 English (KStg3): Year 7: 7x/En2	11:10-12:10 Geography (KStg3): Year 7: 7X/Ge5	11:10-12:10 History (KStg3): Year 7: 7xy/Hi2	11:10-12:10 Science (KStg3): Year 7: 7x/Sc2
12:10-13:10 French (KStg3): Year 7: 7xy/Fr2	12:10-13:10 Technology (KStg3): Year 7: 7x/Te5	12:10-13:10 Mathematics (KStg3): Year 7: 7x/Ma1	12:10-13:10 Ethics and Beliefs (KStg3): Year 7: 7xy/Ep2	12:10-13:10 IT (KStg3): Year 7: 7xy/It2
13:55-14:55 English Accelerated Reader (KStg3): Year 7: 7x/Er2	13:55-14:55 Science (KStg3): Year 7: 7x/Sc2	13:55-14:55 PE (KStg3): Year 7: 7x/Pe4	13:55-14:55 French (KStg3): Year 7: 7xy/Fr2	13:55-14:55 English (KStg3): Year 7: 7x/En2

Timetable example (Detail)



7x/Sc2

X = side of the year

Sc = subject (science)

2 = group number

S8 = Classroom

Dr Friar = teacher

P3 (11:10-12:10)	P4 (12:10-13:10)	P5 (13:55-14:55)
Science (KStg3): Year 7: 7x/Sc2 S8 Dr Friar	French (KStg3): Year 7: 7xy/Fr2 ML4	English Accelerated Reader (KStg3): Year 7: 7x/Er2 LIBB Mrs Wheeler
English (KStg3): Year 7: 7x/En2 E4 Mrs Richbell	Technology (KStg3): Year 7: 7x/ Te5 T4 Miss Rees	Science (KStg3): Year 7: 7x/Sc2 S8 Dr Friar

Tutor Morning Rota



Monday	Planner Checks
Tuesday	Current Affairs
Wednesday	Literacy/ Numeracy
Thursday	Silent Reading
Friday	Assembly

Equipment

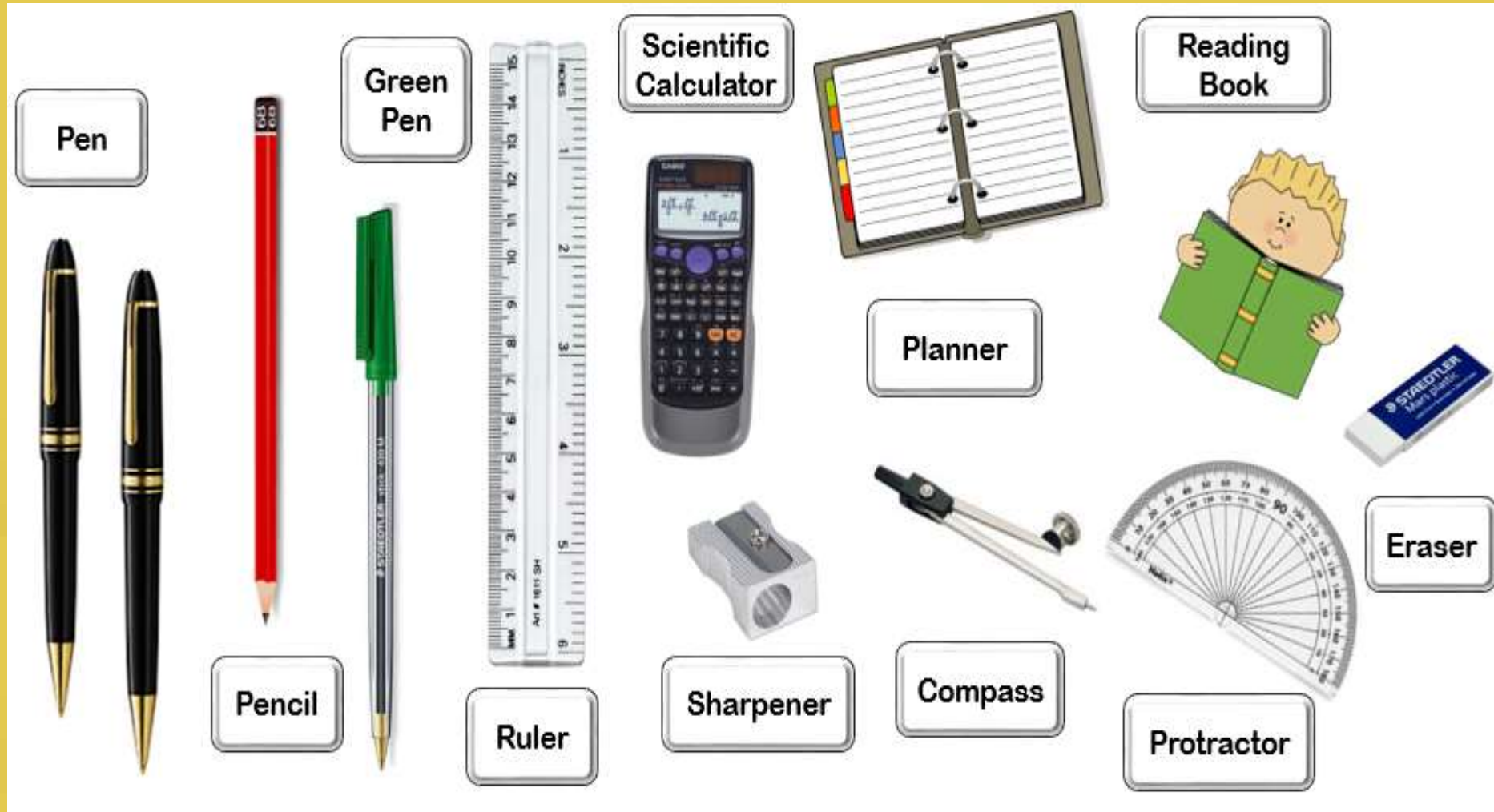

Uniform



Jewellery

- One earring in each lobe
- One Watch
- No bracelets or rings

No make up



Blazer

House Tie

Badges

Skirt - black and pleated

Black shoes.

No colour or air bubble

White Shirt

Jumper - optional

Trousers (black)

or Shorts (plain black or grey tailored)

Rewards



Students are rewarded regularly at Testwood School for a wide range of reasons, which may include:

- Contributions to lessons
- Completing a good piece of work in class
- Completing an outstanding piece of homework
- Contributions to extra-curricular
- Helpful to staff or peers

This could be in the form of:

- House points
- Certificate/postcard/letter/phone call home
- Subject badges
- Invitation to reward trip
- Nomination to Headteacher's Tea Party
- REWARD DAY!!!

Reward Day



Sanctions



Students will receive a sanction if they are not following the school rules, which may include:

- Being late to school
- Not completing sufficient classwork or homework
- Unsafe and dangerous behaviour

This could be in the form of:

- Phone call or letter home
- After School Repair - up to 2 hours
- In serious cases, internal or external exclusion

Please refer to our Behaviour for Learning Policy which is on our website for further clarification.

Attendance

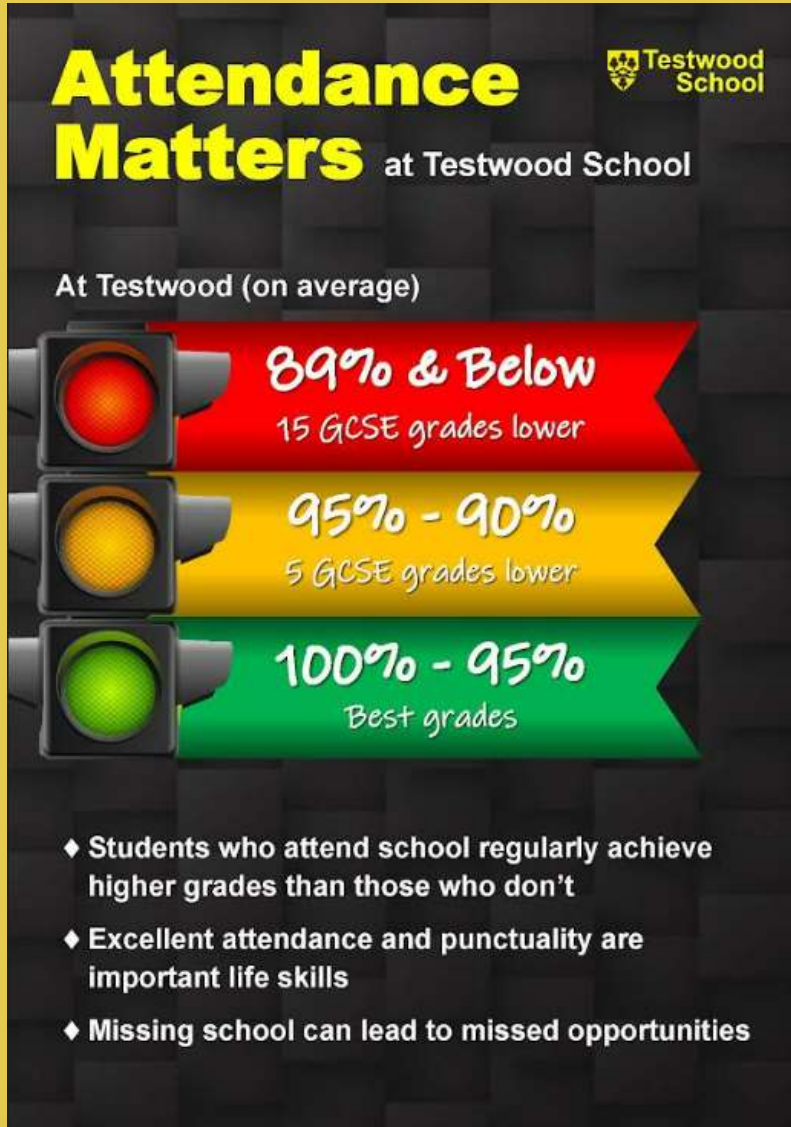

Attendance Matters at Testwood School

At Testwood (on average)

Attendance Range	GCSE Grades Lower
89% & Below	15 GCSE grades lower
95% - 90%	5 GCSE grades lower
100% - 95%	Best grades

- ◆ Students who attend school regularly achieve higher grades than those who don't
- ◆ Excellent attendance and punctuality are important life skills
- ◆ Missing school can lead to missed opportunities

- Children are encouraged to be in school daily by **no later than 8.20am** in preparation for a **8.30am** start to the school day
- Children are set an attendance target of **100%** when they arrive in Year 7.
- If your child's attendance drops significantly below this figure then Tutor, Head of Year or Miss Pope (Attendance Officer) will be in contact to discuss.

Absence Procedure



□ Child absence due to illness

- Phone through to the front office and inform the school before 9.00am that your child will be absent

□ Child absence due to medical

- If your child needs to attend a medical appointment then please inform the school via the original appointment letter, a note or phone call. Where possible make appointments outside school hours.

□ Request for leave of absence

- This can only be granted in exceptional circumstances by Mr Webber (Head Teacher)

□ **Truancy Procedure**

- If Testwood does not hear from a parent regarding a child's absence they will go onto our Truancy Procedure. A text message will be sent every hour until Testwood gets a response.

Your Aims



Be Ready

Be Respectful

Be Responsible



Caring | Inclusive | Ambitious |